

Current part is item (15) on diagram. Available at [www.oshkoshequipment.com](http://www.oshkoshequipment.com)

(1) FIG. NO.	(2) ITEM NO.	(3) SMR CODE	(4) NATIONAL STOCK NUMBER	(5) PART NUMBER	(6) FSCM	(7) DESCRIPTION USABLE ON CODE	(8) U/M INC IN UNIT
						0607-INSTRUMENT OR ENGINE CONTROL PANEL (CONT'D)	
63	10	PAOZZ	5310-00-045-3296	MS35338-43	96906	WASHER, LOCK	EA 2
63	11	PAOZZ	6685-00-936-2139	MS24543-2	96906	INDICATOR, TEMPERATURE	EA 1
63	12	PAOZZ	5310-00-934-9751	MS35650-302	96906	NUT	EA 2
63	13	PAOZZ	5310-00-045-3296	MS35338-43	96906	WASHER, LOCK	EA 2
63	14	PAOZZ	6685-00-515-3478	7954512	19207	GAGE, PRESSURE, DIAL: AIR PRES- SURE, 120 PSI MECHANICAL	EA 1
63	15	PAOZZ	6625-00-321-6365	MS24532-2	96906	METER, ARBITRARY: BATTERY AND GENERATOR	EA 1
63	16	PAOZZ	6680-00-933-3600	MS24544-2	96906	INDICATOR, LIQUID QUANTITY: FUEL, W/CLAMP	EA 1
63	17	PAOZZ	6620-00-938-8212	MS24541-2	96906	INDICATOR, PRESSURE	EA 1
63	18	PAOZZ	5305-00-245-3435	451589	21450	SCREW, MACHINE	EA 6
63	19	PAOZZ	5310-00-045-3299	MS35338-42	96906	WASHER, LOCK	EA 6
63	20	PAOZZ	6210-00-699-9458	8376500	19207	LIGHT, INDICATOR	EA 2
63	21	PAOZZ	6210-00-337-7345	7358622	19207	LENS, LIGHT	EA 1
63	22	PAOZZ	6240-00-266-9940	MS25231-1829	96906	LAMP, INCANDESCENT	EA 1
63	23	PAOZZ	6210-00-699-9457	8376499	19207	LIGHT, INDICATOR	EA 1
63	24	PAOZZ	6210-00-299-5564	7538622	19207	LENS, LIGHT	EA 1
63	25	PAOZZ	6240-00-266-9940	MS25231-1829	96906	LAMP, INCANDESCENT	EA 1
63	26	PAOZZ	5325-00-753-9255	7533778	19207	RECEPTACLE, TURNLOCK	EA 4
63	27	PAOZZ	5310-00-752-6591	7526591	19207	PUSH ON NUT	EA 4
63	28	PAOZZ		7526590	02728	STUD, TURNLOCK	EA 4
63	29	XBOZZ		7971605	19207	PANEL AB, AC	EA 1
63	29	XBOZZ		7971603	19207	PLATE, MOUNTING AA	EA 1
63	NI	PAOZZ	5930-00-296-6319	MS39061-2	96906	SWITCH, TOGGLE, MANIFOLD HEATER	EA 1
63	NI	XBOZZ		11609408	19207	HANDLE, GRAB	EA 1

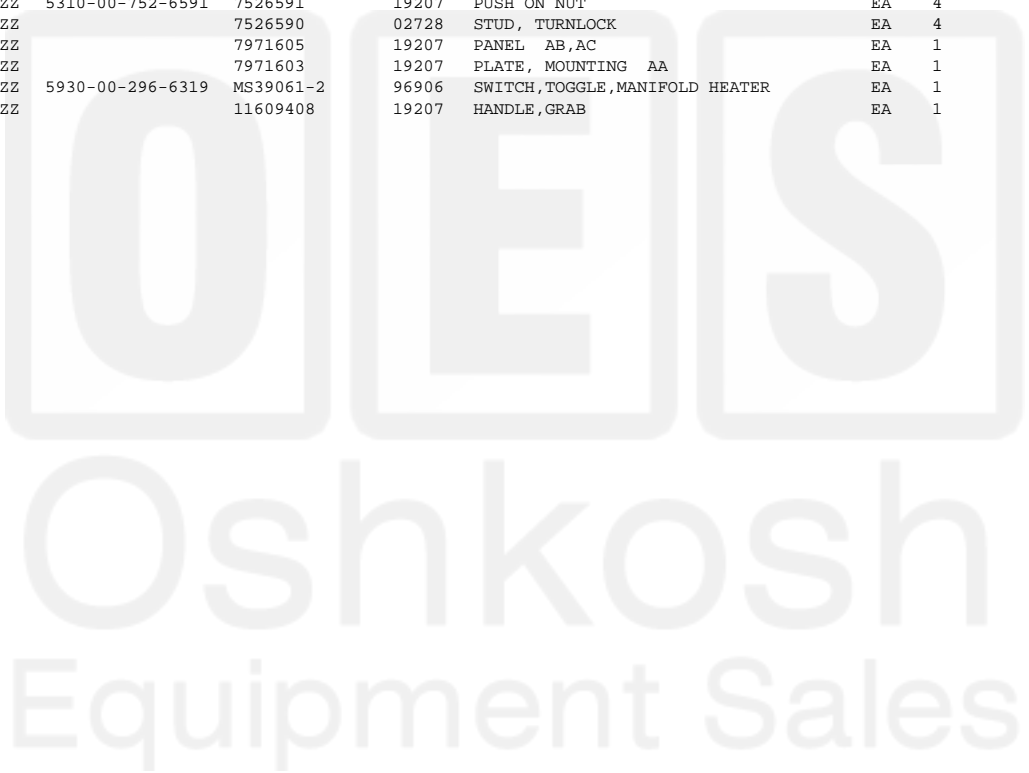

Current part is item (15) on diagram. Available at [www.oshkoshequipment.com](http://www.oshkoshequipment.com)

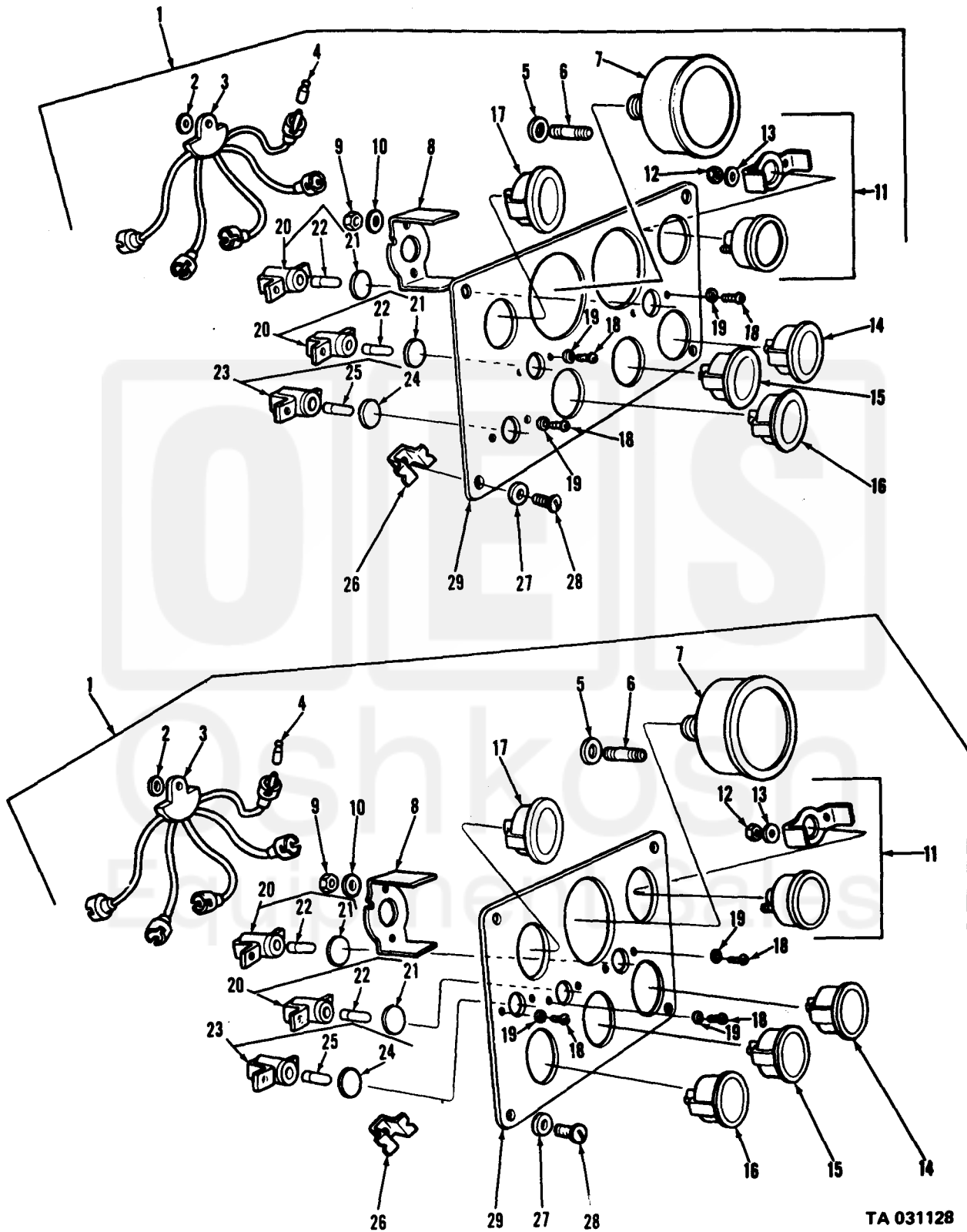

Figure 63. Instrument cluster assembly